

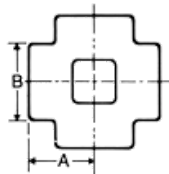

## DIMENSIONAL DATA

### Threaded Cross



Class 2000	Nominal Pipe Size	1/8	1/4	3/8	1/2	3/4	1	1 1/4	1 1/2	2	2 1/2	3	4
	A	-	7/8	31/32	1 1/8	1 5/16	1 1/2	1 3/4	2	2 3/8	3	3 3/8	4 3/16
B	-	29/32	1 1/16	1 5/16	1 9/16	1 27/32	2 7/32	2 1/2	3 1/32	3 11/16	4 5/16	5 3/4	
Wt	-	0.500	0.460	0.777	1.125	1.688	2.450	3.188	5.560	16.438	19.500	32.688	
Class 3000		1/8	1/4	3/8	1/2	3/4	1	1 1/4	1 1/2	2	2 1/2	3	4
	A	7/8	31/32	1 1/8	1 5/16	1 1/2	1 3/4	2	2 3/8	2 1/2	3 1/4	3 3/4	4 1/2
B	29/32	1 1/16	1 5/16	1 9/16	1 27/32	2 7/32	2 1/2	3 1/32	3 11/32	4	4 3/4	6	
Wt	0.438	0.567	0.970	1.500	2.500	3.620	4.125	6.500	8.125	16.750	25.675	32.000	
Class 6000		1/8	1/4	3/8	1/2	3/4	1	1 1/4	1 1/2	2	2 1/2	3	4
	A	31/32	1 1/8	1 5/16	1 1/2	1 3/4	2	2 3/8	2 1/2	3 1/4	3 3/4	4 3/16	4 1/2
B	1 1/6	1 5/16	1 9/16	1 27/32	2 7/32	2 1/2	3 1/32	3 11/32	4	4 3/4	5 3/4	6	
Wt	0.563	1.188	1.500	2.750	4.313	6.625	10.750	11.500	22.188	27.500	54.000	43.500	